

ALTERNATORS

CTP alternators utilize the most modern technology to provide unmatched performance for a reliable charging system. Assembled only with premium components to ensure and meet strict quality manufacturing standards. The units are performance tested to guarantee long term dependable service. CTP alternator units are designed and manufactured to withstand the extreme conditions found in today's heavy duty equipment while delivering dependable charging power.

Part No.	Volts	Amps	Engine Model	Machine
969299	24V	30A	N/A	E200B
1005047	24V	50A	3406/C, 3408/E, 3306, 3116	16H, 627F, 631E, 769C, 12H, 120H, 583R
1008223	12V	55A	3054, 3056	TH62, TH103, TH63, INDUSTRIAL
1052811	12V	55A	3046	939/C, D4C/LGP, D5C, 933
1052812	12V	55A		416B, 416C, 416D, 420D, 424D, 426B, 426C, 428B, 428C, 428D, 430D, 432D, 436B, 436C, 438B, 438C, 438D, 442D, 908, TH103, TH62, TH63, TH82, TH83
1052813	12V	90A	3054/B/C	426C, 428C, 436C, 424D, 416D
1052814	12V	90A		236B, 236B3, 242B3, 246C, 252B, 252B3, 256C, 257B3, 259B3, 262C, 262C2, 267B, 268B, 272C, 277C, 277C2, 279C, 279C2, 287C, 287C2, 289C, 289C2, 297C, 299C, 3044C, 906, 906H, 907H, 908, 908H, 933, 933C
1077977	24V	70A	3116, 3306, 3196, 3176, 3406C	D6M/LGP, DR7, 365B, 572R, 966G
1092362	24V	55A	3056/E, 3054/T	M322C, M315, 312, 317/N, M318C
1125041	24V	50A	3406/C, 3408/E, 3412, 3116	16H, 627F, 16G, 637E, 120H, 826C
1171379	12V	130A	C7, C9, C12, C16, 3126B	460, 85C, 470 R, 480 R, 75C, TH31-C91
1214134	12V	115A	3176B, 3406C, C15, 3456, C13	TRUCK, INDUSTRIAL, PETROLEUM
1252994	24V	50A		311D LRR, 312D, 312D L, 313D, 314D CR, 314D LCR, 315D L, 318D L, 319D, 319D L, 319D LN, 320B, 320B FM LL, 320B U, 320C, 320N

* Other part no. not included in the list are available. Please contact your sales representative if you have any questions. Part Numbers are used for reference purposes only. Komatsu® is the registered trademark of Komatsu Ltd.

ALTERNATORS - Cont.

Part No.	Volts	Amps	Engine Model	Machine
1259597	12V	145A	C7, C13, C9, 3196, 3176, 3126B	95E, 75D
1397850	24V	35A		305.5, 306, 307B, 307C, 307D, 308C, 308D
1449952	12V	55A		216, 301.5, 302.5, 303.5, 304.5, 902
1449954	12V	55A		216, 228, 236, 247, 248, 267, 287, 906
1492061	12V	65A	4.236	N/A
1557434	24V	70A		924G, 924GZ, 928G, IT28G
1693345	24V	60A	3406C, C15, C7, C13, 3412E	16H, TH35-C15I, 771D, 627F, C280-16
1779953	24V	80A		120H, 120H NA, 12H, 12H ES, 12H NA, 12M, 135H, 135H NA, 140G, 140H, 140H NA, 140M, 14H NA, 160H, 160H ES, 160M, 16H NA, 320C, 320C FM, 320D, 320D FM, 320D FM RR, 322C, 322C FM, 324D FM, 324D FM LL
1855294	24V	65A	3406E, C7, C13, C9, C15, 3126B	740, D8R, 336D2, 340D2, M325D
1978820	24V	95A	3516, C7, C15, 3516B, 3512, 3508B	789C, 793C, D8T, 140K, D9T, 784C
2002232	24V	75A	C15, 3406E, C18, 3408E, 3176C, 31966	740B, 657G, 631E, 623G, 633E, 160H
2008281	24V	75A	3406E, 3408/E, C15, 3456, 3126B, C9	740, D9N, 623G, 621G, D8L, 651B, 657B
2035492	12V	110A	3044C, C3.4, 3046, 3034,	277C, 259B3, 246C, 939C, D5C, 236, 246
2047449	24V	100A	3408C, 3456, C9, 3176C	D9R, 836G, D6R, D8R, D7R
2076036	12V	105A		TH220B, TH330B, TH340B, TH350B, TH355B, TH460B, TH560B, TH580B
2128561	24V	54A	C6.4, 3066	323D, 320D
2128622	24V	50A	3064, 3066	311C U, 320C/L
2253143	12V	85A	C4.4	AP-300D
2267683	24V	95A	C32, C18, C27, C7.1, C15, C9.3, C6.6	777F, D11T, 772G, 390F, 563C, 775F, D6T
2339533	24V	55A	3054C, 3054E	315C, AP-650B, AP-800D, CP-433E, CP-533E, CS-423E, CS-433E, CS-533E, PF-300C, PS-150C, PS-360C
2357132	24V	65A	C13, C15, C18, C27, C32, C9.3	627H, 627K, 627K LRC, 938H, CX31-C13I, CX31-C18I, CX35-C18I, IT38H
2357133	24V	80A	C13, C9.3, C11, C7.1, C15, C6.6	972H, 366F, 14M, 329E, 352F-VG, 623G
2490313	24V	150A	C9	120M, 12M, 140M, 160M, 24H, 24M, 583T, 587T, 924H, 924HZ, 928HZ, D6R, D6R III, D6R STD, D6T, D7R II, D7R XR, D8R, D8T, PL83, PL87
2579466	24V	95A		826H, 834H, 836H, 988H
2637672	24V	N/A	C2.2, C4.4	
2667224	12V	110A	C7, C15, C9, 3406C, 3126B, C18	MARINE, PETROLEUM, INDUSTRIAL
2667226	24V	75A	3516B, C18, C7, C32, C9	MARINE, INDUSTRIAL
2667227	24V	60A	C15, 3508, 3406C/E, C7, C13, 3456	MARINE, INDUSTRIAL, TRUCK, PETROLEUM
2721889	24V	150A	C13, C6.6, C32, C9.3, C7.1, C15	16M, 930K, D11T, 797F, 725C, 938K, D8T
2988838	24V	65A	C15, C9, CG137-08, CG137-12, G3408C, G3412, G3508, G3508B, G3512, G3512B, G3516, G3516B, G3520B, G3606B	
3062174	24V	150A	C13, C7, C15, 3512B, C27, 3516C	587T, 583T, D6R, D8T, D7R
3167251	24V	105A	3516, 3406C, C7, C18, 3412E, 3512B, C15	793C, 789C, 16H, 793B, 5110B, 785B, 777C
3218932	24V	85A	C4.4, C7.1	312E, 312E L, 314E CR, 314E LCR, 316E L, 318E L

* Other part no. not included in the list are available. Please contact your sales representative if you have any questions. Part Numbers are used for reference purposes only. Komatsu® is the registered trademark of Komatsu Ltd.

ALTERNATORS - Cont.

Part No.	Volts	Amps	Engine Model	Machine
3315717	24V	105A	3516C, 3508/B, 3512B, C7, C13	INDUSTRIAL, MARINE
3331184	24V	60A	3116, 3126, 3126B, 3176B, 3176C, 3196, 3304, 3306, 3306B, 3406, 3406B, 3406C, 3406E, 3408, 3408B, 3408C, 3408E, 3412, 3412C, 3412D, 3412E, 3456, 3508, 3508B, 3508C, 3512, 3512B, 3512C, 3516, 3516B	
3397766	12V	85A	3024C, 3054C, 3054E, 3056E, C4.4	216, 216B, 232B, 242B, AP-300D, CB-54, CB-64
3397767	12V	65A	C6.6, C4.4, C3.3, 3054C, 3056	INDUSTRIAL
3445081	24V	115A		320D2, 320D2 GC, 320D2 L, 323D2 L, 525D, 535D, 545D, 555D, 730C, 735B, 740B, 770G, 772G, 773G, 773G LRC, 775G, 775G LRC, 777G, 924K, 930K, 938K, 950 GC, 950K
3469824	12V	100A	C6.6, C4.4, C3.4	TL1255C, TL943C, TL1055C
3469825	12V	120A		416D, 416E, 420D, 420E, 420F, 422E, 424D, 428D, 428F, 430E, 430F, 432D, 432F, 434E, 434F, 442D, 444F, 450E, D3K XL, D4K XL, D5K LGP
3469826	24V	55A	C2.2, 3056E, 3024C	CS-563E, INDUSTRIAL
3469827	24V	75A	C4.4	CS54B, CP54B, 420E, CS44, CP44
3491369	12V	85A	3024C	INDUSTRIAL
3524700	24V	145A	C13, C15, C18, C27, C32, C7.1, C9.3	621H, 621K, 623H, 623K, 623K LRC, 627H, 627K, 627K LRC, 966M, 966M XE, 972M, 972M XE, 980M, 982M, CX31-C13I, CX31-C18I, CX35-C18I
3662756	24V	115A		120K, 120K 2, 12K, 140K, 140K 2, 160K, 950H, 962H, 980H, 986H, D6R, D6R STD, D7R XR
3776966	12V	100A		272D, 272D XHP, 299D, 299D XHP, 910K, 914K
3832556	12V	100A	C6.6, C4.4, 3054C	416E, 414E, 422E, INDUSTRIAL
3832557	12V	120A	3054C, 3054E, 3056E, C4.4, C6.6	414E, 416D, 416E, 416F, 420D, 420E, 420F, 422E, 422F, 424D, 428D, 428E, 428F, 430D, 430E, 430F, 432D, 432E, 432F, 434E, 434F, 442D, 442E, 444E, 444F, 450E, CB-54B, D3K
3851812	24V	115A		924K, 930K, 938K
3943494	12V	65A	3013C, 3024, 3024C, C1.5, C2.2	AP-255E, BB-621C, CB-214E, CB-22, CB-334E, CB-34
3943496	12V	85A	3013C, 3024C, C1.5, C2.2	216B, 216B3, 226B, 226B3, 232B, 242B, 247B, 247B3, 257B, CB22B, CB24B, CB32B, CB34B, CB34B XW, CC24B, CC34B
3979953	12V	80A		236D, 242D, 246D, 257D, 259D, 262D, 277D, 279D, 287D, 289D, 906H2, 907H2, 908H2
3991485	24V	75A	3054C, 3054E, C4.4, C6.6	420E, 914G, AP-600D, AP-655D, AP1000E, AP1055E, AP555E, BG500E, BG600D, BG655D, CP-56, CP-76, CS-54B, CS-64, CS-74, IT14G, IT14G2, M313D, M315C, M315D, M315D 2, M316D, M317D
4246821	24V	55A	3054C, 3054E, 3056E, C4.4	312D2, 312D2 GC, 312D2 L, 313D2, 313D2 LGP, 318D2 L, AP-650B, AP-800D, BB-760, CP-433E, CP-533E, CP-573E, CP-663E, CS-423E, CS-433E, CS-533E, CS-563E, CS-583E, CS-663E
4396444	12V	45A		303E CR
2Y8310	24V	21A	3304, 3306/B, 3408B	D4E, D5E, 966C, 930T, 140B, 930R
3E7577	24V	75A	3512C, 3408E, 3456, 3306, 3508B, 3406	385B, D8R, 627F, 12H, 797B, 797, 16H
3E7772	24V	60A		914G, IT14G

* Other part no. not included in the list are available. Please contact your sales representative if you have any questions. Part Numbers are used for reference purposes only. Komatsu® is the registered trademark of Komatsu Ltd.

ALTERNATORS - Cont.

Part No.	Volts	Amps	Engine Model	Machine
3E7892	12V	85A	3408C, C27, 3412E, C32, C9,	HT400, CX31-C9I, TH48-E70-C27I
4N3987	32V	60A	3304, 3306, 3406, 3406B, 3406C, 3408, 3408C, 3412, 3412C, 3412D, 3412E, 3508, 3512, 3516, D342, D342C, D343, D346, D348, D349, D353C, D379, D379A, D379B, D398, D398A, D398B, D399, G342C, G353D, G379	
5I5178	24V	50A	S6KT	EL200B
5I7615	24V	50A	3066	320, 320 L
5I8085	24V	55A		311, 311B, 311C, 312, 312B, 312C, 312C L, 314C, 315, 315B, 315B FM L, 315C, 317B LN, 318B, 318C, 319C, 320 L, 320B, 320B L, 320B U, 320C, 320C FM, 320N, 321B, 910G
5N5692	24V	45A	3512C, 3406E, C15, C18, C7	INDUSTRIAL, TRUCK, PETROLEUM
6N9294	24V	35A	C7, 3406C, 627F, 3508B, 3306	140K, 627F, 12H, INDUSTRIAL, GAS, PETROLEUM
6T1195	12V	61A	4.236	CS323, CP-323
6T1395	24V	35A	C15, 3406C, 3408C, G3306B	GAS, INDUSTRIAL, PETROLEUM, MARINE
6T1396	12V	51A	C15, 3406E, G3304, 3306, 3208	MARINE, INDUSTRIAL, GAS
7G7889	12V	60A	3406C, C13, C7, 3412, C9, C18	PETROLEUM, INDUSTRIAL, GENERATOR SET
7N4784	12V	40A	3204	IT12, 935C, 931C, D3C, 931B, 910, D4C, D3C
7N6118	12V	40A	3204	931, D3/LPG, 910
8N2268	12V	75A	3204	IT12, 935C, D3C, 931C, 910, D4C, D5C, 931B
9G6079	12V	61A	3208, 3204	D3B, INDUSTRIAL, TRUCK
9W3043	24V	52A	3054, 3116, 3126, 3208, 3056E	M318, CS-563E, 938G, IT28G, IT38G, 322C/LN,

ALTERNATORS FOR KOMATSU®

Part No.	Volts	Amps	Engine Model	Machine
600-821-6130	24V	35A	S4D105, S4D95L	6D105, 6D95L, DCA, EGS160, EGS190
600-825-6110	24V	60A	S6D140E, SA6D140, SA6D140E, SAA6D140E	HM350, HM400
600-861-6410	24V	60A	S4D102E, S6D102E, SA6D102E, SAA4D102E, SAA6D102E	6D102E, PC200, PC220
600-861-6420	24V	60A	SAA4D102E, SAA4D107E, SAA6D102E, SAA6D107E	PC160, PC200, PC200LL, PC220, PC220LL, PC240, PC270, PC290, PW180, PW200, PW220
600-861-9120	24V	90A	SAA4D107E, SAA6D107E, SAA6D114E, SAA6D140E, SAA6D170E	GD655, WA200PZ, WA250PZ, WA320PZ, WA380, WA430, WA500
6735-82-9210	24V	40A	S6D114-E1	

* Other part no. not included in the list are available. Please contact your sales representative if you have any questions. Part Numbers are used for reference purposes only. Komatsu® is the registered trademark of Komatsu Ltd.

RELIABILITY AND DURABILITY

In order to deliver a dependable and quality performance, CTP Alternators ensure wear resistance and trustworthiness due to top-notch technology

Over-voltage shutdown: Limits voltage if output terminal becomes disconnected from the battery.

Open-sense shutdown: Shuts down alternator if sense terminal goes open.

Load-dump protection: Protects the transistor from transient voltage spikes.



REGULATOR

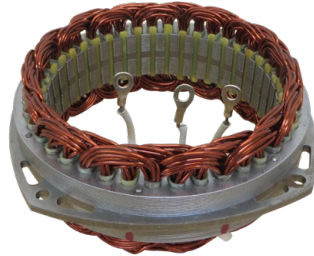

STATOR

Delivers absolute consistency; 100% tested – Guarantees dependability; Polyester heavy-coat wire. Ensures regular coating for electrical reliability, quality performance, rated 180°C.



BEARING

CTP Bearings are made with top quality seals to extract grease pollution and leakage.

- Bearings use performance grease.
- Protection from excessive temperatures from -40°F up to 392°F (-40°C to 200°C)
- Load-dissipating thickness guarantees long service lifespan and protects it against thermal and motorized shock.

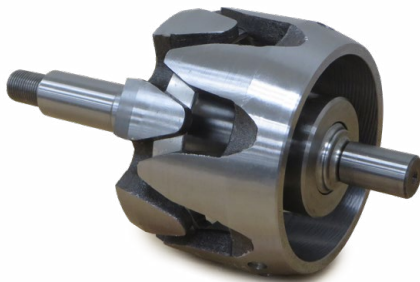

ROTOR

Rotor shafts are CNC-machined and precision-ground for precise proportions and a smooth finish.

Splines and bearing exteriors are heat-treated. Wire and varnish rated 1800C.

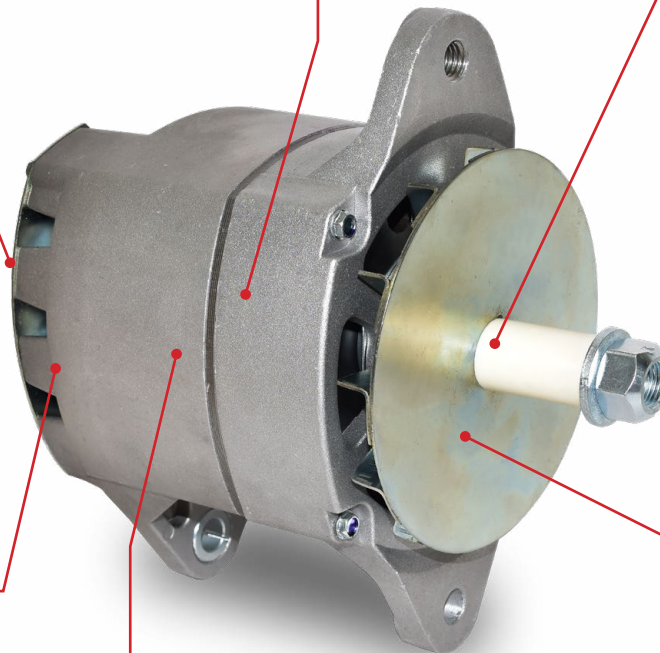

Part No. 6N9294

FAN

Extracts heat and keeps the alternator cool.

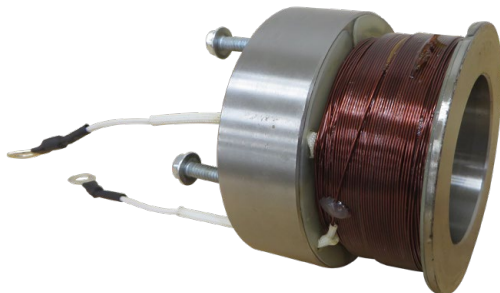

FIELD COIL

Field Coil has been separated from the rotor; thus, brushes have been eliminated, creating more durability and consistency.

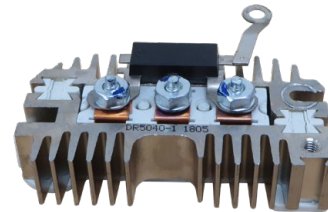

RECTIFIER

Rectifier: It rectifies current from AC to BC.